



# wetDRY Diamond Hole Saws

10087 / 10080 / 10075 / 10071

1-3/8"  
Wet/Dry  
Diamond Hole Saw



10087

5/16"  
Wet/Dry  
Diamond Hole Saw



10080

1/4"  
Wet/Dry  
Diamond Hole Saw



10075

3/16"  
Wet/Dry  
Diamond Hole Saw



10071

## How to use:

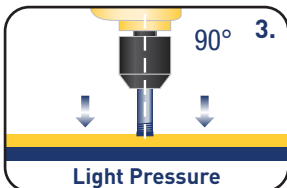
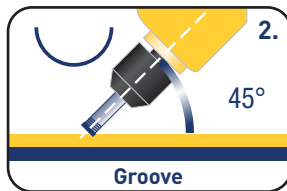
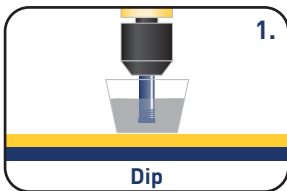

**UP TO 12 TIMES  
LONGER LIFE THAN  
A STANDARD WET HOLE SAW**

SCAN HERE FOR  
PRODUCT INFO



The QEP® wetDRY Diamond Hole Saws are designed for the easy, fast and accurate cutting of porcelain, ceramic and glass tiles. These hole saws feature a special diamond grit edge for faster and smoother cuts, while using less water than conventional diamond drill bits. Simply dip the hole saw into water and drill the desired hole for professional quality and results.

Professional Tools for Professional Results

QEP.com