

# Tile Leveling System

## CLIPS

PART

**A**

2-part system (sold separately)

For Tiles up to 1/2" Thick

## WEDGES

PART

**B**

**A**



**LEVEL**  
Flat base notched for maximum adhesive coverage

**4 CLIP SIZES**  
Available in four popular grout widths  
1/32", 1/16",  
1/8" and 3/16"

**DESIGN**  
Notches on each side of the clip allow clear break well below tile surface

**TILE SIZE**  
Opening accommodates tiles up to 1/2" thick

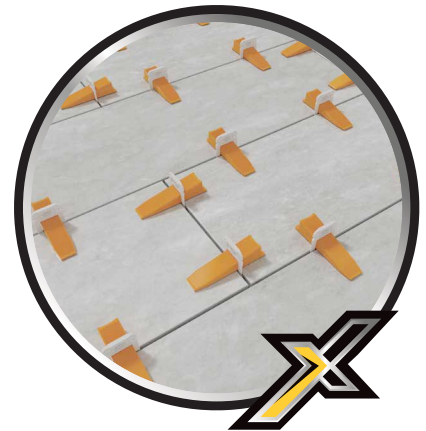

**HOLD**  
Ensures the surface is lippage-free while the mortar dries

**B**

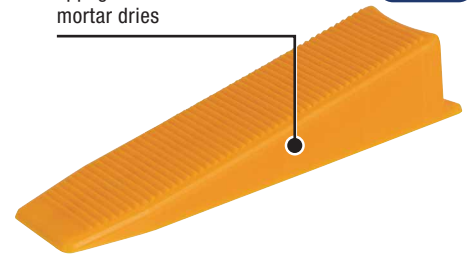

SCAN HERE FOR PRODUCT INFO



The Tile Leveling System was developed out of a need to diminish costly mistakes due to unlevelled tiles causing lippage in high-end installations. It is the perfect system to use with tile plank and large-format rectified porcelain, marble and stone and the flat base design is ideal for wall tile installations. This time saving system adjusts the height of the tiles and evenly holds their edges throughout the curing process. It is the most cost effective installation method on the market to eliminate lippage.

The Tile Leveling System comes in 4 clip sizes with 1/32", 1/16", 1/8" and 3/16" and provides narrow grout lines for tiles up to 1/2" thick. Wedges are 7/8" wide and can be collected and reused.

## Easy to install and remove!



**1**  
Clean excess thinset along tile edge

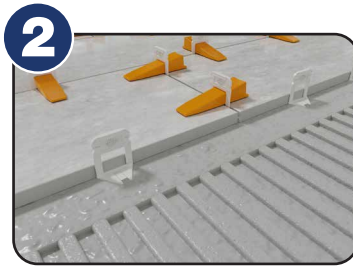

**2**  
Insert Clip

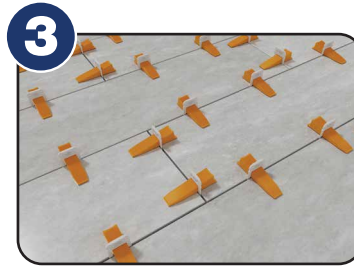

**3**  
Secure wedge

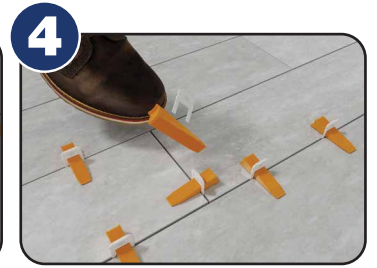

**4**  
Once the mortar sets, remove in direction of grout line within 24 hours

The Wall & Floor Tile Leveling System should be used with a minimum 1/2" x 1/2" x 1/2" square trowel notch to apply the setting material. Back buttering your tile is always recommended.

Type	Item #	Quantity	Type	Item #	Quantity
<b>A</b> 1/32"	99751	100/Bag (8/case)	<b>A</b> 1/8"	99769	100/Bag (8/case)
	99771	500/Box (8/case)		99869	300/Box (4/case)
	99871	1000/Box		99773	500/Box (8/case)
	99776	2000/Box		99873	1000/Box
<b>A</b> 1/16"	99761	100/Bag (8/case)		99778	2000/Box
	99861	300/Box (4/case)		<b>A</b> 3/16"	99774
	99772	500/Box (8/case)	99779		2000/Box
	99872	1000/Box	<b>B</b> Wedges	99762	100/Bag (8/case)
	99777	2000/Box		99862	300/Box (4/case)
		99775		500/Box (8/case)	
			99780	2000/Box	

## 99784 Pro Pliers

### PERFORMANCE

Stop pin allows for proper pressure

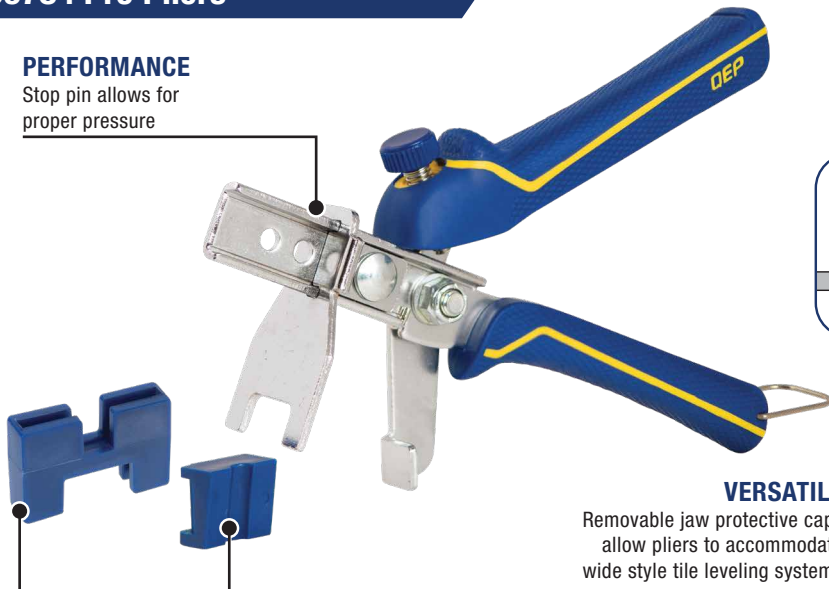

### VERSATILE

Removable jaw protective caps allow pliers to accommodate wide style tile leveling systems

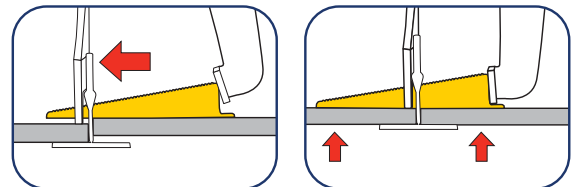

- Ensure wedges are set properly in the leveling clips every time (One to Two Clicks)
- Can also be used with the Original LASH® Tile Leveling System and all similar Tile Leveling Systems