

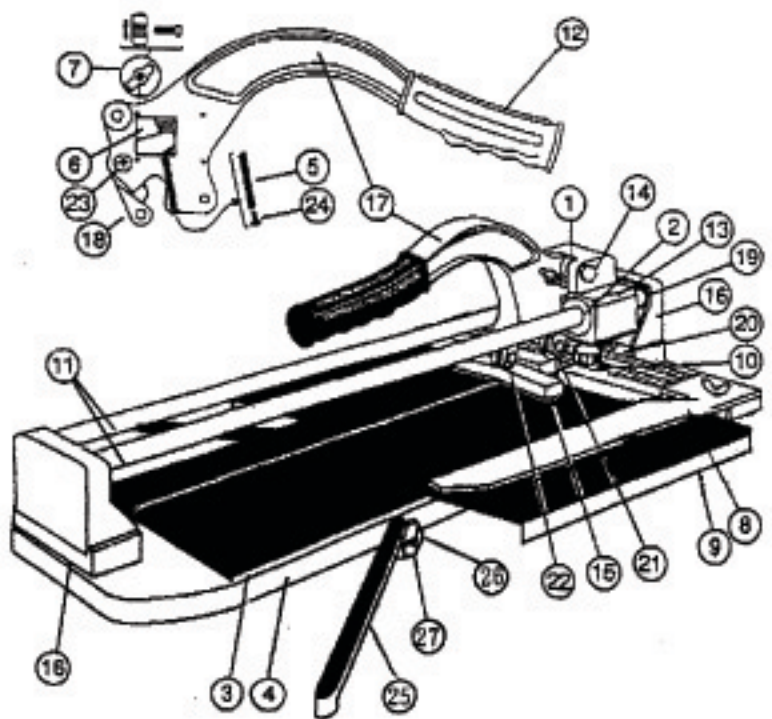

No. 10700 28" Super Clinker Tile Cutter

ORDER NO.	DESCRIPTION
10700*	Box
10700-01	Pivot Arm Bearing
10700-02	Bearing Caps (2)
10700-03	Rubber Pads (2)
10700-04	Aluminum Base
10700-05	Wheel Holder Spring
10700-06	Adjustment Cam
10700-07	Cam Knob w/Washer & Screws
10700-08	300mm Wide Guide
10700-09	(150mm)6" x (300mm)12" Extensions (2pcs.)
10700-10	Wing Screw & Washer
10700-11	Rail Bars (2)
10700-12	Red Handle Grip
10700-13	Slide Assembly (Bearing Block)
10700-14	Bolt w/Bushing, Washer & Nut
10700-15	Breaker Bar
10700-16	Brackets
10700-17	Handle Assembly
10700-18	Wheel Holder
10700-19	Rubber Stoppers (2)
10700-20	Hex Bolt, Flat Washer, & Spring Washer
10700-21	6x25mm Hex, Bolt, 6mm Spring Washer, & Nut
10700-22	6x30mm Hex, Bolt, 6mm Spring Washer, & Nut
10700-23	6x16mm Flat Head Screw
10700-24	6x16mm Binding Head Screw
10700-25	(300mm)12" Long Aluminum Arms
10700-26	Aluminum Connector of Side Base
10700-27	White Round Head Screw
21119	7/8" Tungsten Carbide Ball Bearing Cutting Wheel





ORDER FORM

ORDER NO.	DESCRIPTION	QUANTITY	PRICE	TOTAL

Subtotal	
Shipping & Handling	* 7.95
Total Amount	

To Order:

Fax to 561-241-2830

or

Mail to Q.E.P. Co., Inc.
1001 Broken Sound, NW Suite A
Boca Raton, FL 33487

* Shipping & Handling may vary depending on weight and dimensions of product.

Name: _____

Address: _____

City: _____ State: _____ Zip: _____

Phone #: _____ Daytime Phone #: _____

Payment: CHECK VISA MASTER CARD

Credit Card #:

Expires: / /

Billing Credit Card Zip Code: -

Signature: _____ Date: _____